

City of Springfield 2010 Slurry Seal Project
Day 1 (Orange)

Street		Yards
1.) V St.	Shady LN. to 2nd St.	4,150
2.) U St.	6th St. West. To about Mid way	1,909
3.) 6th St.	V St. to Northridge Ave	3,199
4.) Q St. CDS	Q St. to CDS	884
5.) 25th St.	J St. to Dubens LN	2,094
6.) H St.	26th St. to 25th Pl.	840
7.) 25th Pl.	H St. to G St.	1,561
8.) 18th St.	H St. to F St.	2,436
9.) D St.	5th St. to 8th St.	4,659
	Total Yards For the Day	21,732

City of Springfield 2010 Slurry Seal Project
Day 2 (Green)

Street		Yards
1.) V st.	2nd St. to 5th St.	2,360
2.) 2nd St.	V St. to U St.	1,239
3.) U St.	2nd St. to New Slurry	1,909
4.) V St.	5th St. to East End CDS	1,391
5.) 8th St.	V St. to Northridge Ave.	2,954
6.) 7th St.	CDS South to End of Post Boards	1,816
7.) 11th St.	Lawnridge Ave to T St.	1,266
8.) Dubens LN	25th St. to 23rd St.	1,482
9.) 18th St.	F St. to E St.	1,201
10.) 16th St.	F St. to E. St.	989
11.) D St.	8th St. to 10th St.	2,330
	Total Yards for the Day	18,937

SLURRY SEAL 2010 P21047

ZONE 1

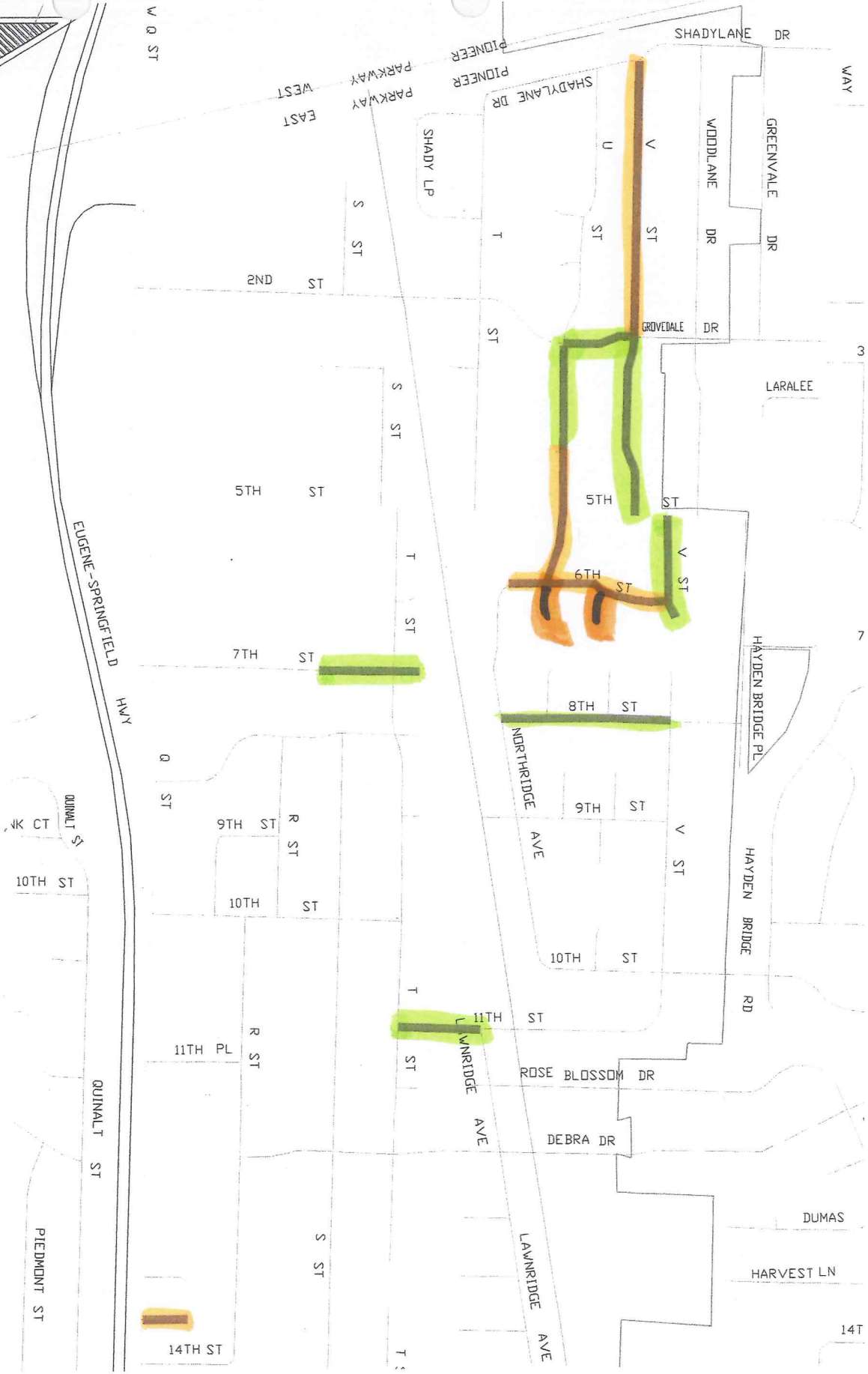
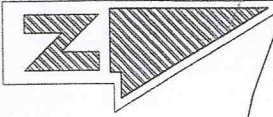

WAY

3

7

14T

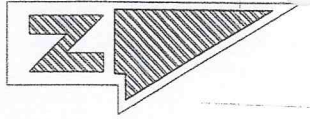

SLURRY SEAL 2010 P21047

ZONE 2

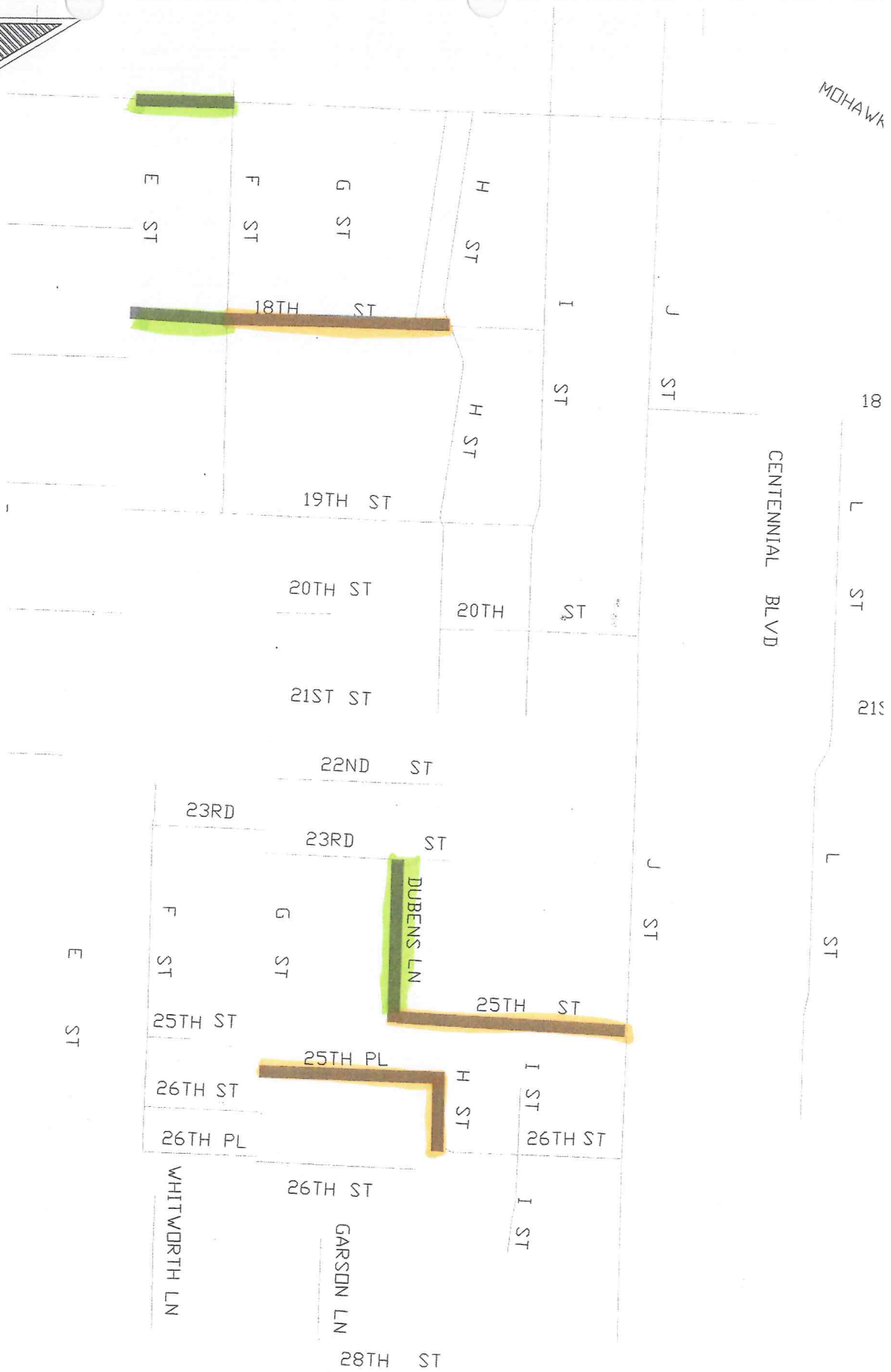

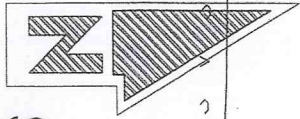

SLURRY SEAL 2010 P21047

ZONE 3

