

SECTION A - A

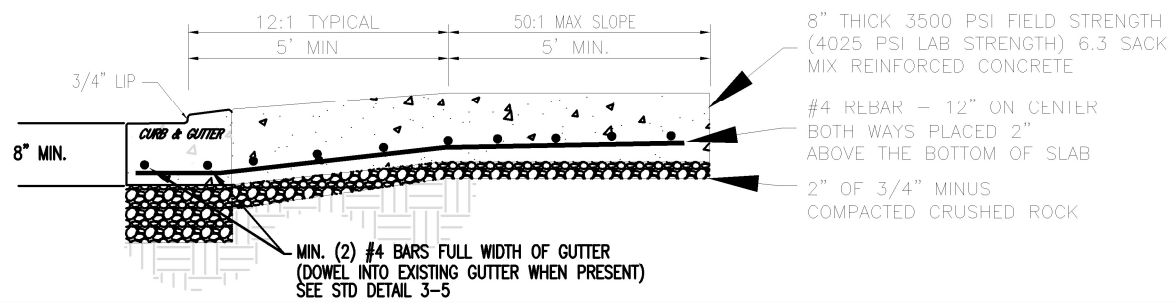

NOTES

- NO ABOVE-GROUND FACILITIES (FIRE HYDRANTS, POWER POLES, CATCH BASINS, VALVES, J-BOXES, ETC.) SHALL BE PERMITTED WITHIN THE APRON OR RAMP AREA
- DRIVEWAY (THROAT) WIDTH SHALL BE BETWEEN 24 FEET (MINIMUM) AND 35 FEET (MAXIMUM) IN ACCORDANCE WITH CITY PERMITS.
- ALL SURFACES SHALL HAVE A BROOM FINISH.
- REFER TO STANDARD DRAWING 3-7 FOR CURB CUT DETAILS.
- CONCRETE WITHIN APPROACH SHALL BE 8" THICK (MIN) CONCRETE ON 2" OF 3/4" MINUS CRUSHED ROCK.
- REINFORCEMENT IS REQUIRED. USE #4 REBAR - 12" ON CENTER - BOTH WAYS - PLACED 2" ABOVE THE BOTTOM OF THE SLAB
- A CONTRACTION (SCORE) JOINT SHALL BE ADDED IN THE CENTER OF THE APRON.
- SIDEWALKS, ACCESS RAMPS, AND RESIDENTIAL DRIVEWAYS SHALL BE 3000 PSI FIELD STRENGTH (3450 PSI LAB STRENGTH) 6.0 SACK MIX CONCRETE
- CURBS & COMMERCIAL DRIVEWAYS SHALL BE 3500 PSI FIELD STRENGTH (4025 PSI LAB STRENGTH) 6.3 SACK MIX CONCRETE

SIDEWALK ACCESS RAMP NOTES

- THIS DRIVEWAY APPROACH MAY NOT BE USED AS A SIDEWALK ACCESS RAMP.

REGISTERED PROFESSIONAL ENGINEER
70925PE
OREGON
JUNE 14, 2007
STANLEY A. PETROFF
EXP DATE: 12-31-2024



COMMERCIAL DRIVEWAY APRON SETBACK SIDEWALK

NO	REVISION	DATE	BY	APPR.
1	DRAWING UPDATE	04/2024	TG	

STANDARD DRAWING
3-24
2024